

Courses & distances down the River from Post.

- No 1 S. 17 1/4 E. 38 perches
- " 2 S. 28 W. 16 "
- " 3 S. 19 1/2 W. 29 "
- " 4 S. 6 1/2 E. 26 "
- " 5 S. 11 1/2 W. 34 "
- " 6 S. 24 1/2 W. 12 "
- " 7 S. 33 3/4 W. 52 "
- " 8 S. 25 W. 26 "
- " 9 S. 38 W. 15 "
- " 10 S. 31 W. 16 "
- " 11 S. 37 W. 24 "
- " 12 S. 28 1/2 W. 17 "
- " 13 S. 36 1/2 W. 26 "
- " 14 S. 27 1/2 W. 24 "
- 15 S. 25 1/2 W. 28 "
- 16 S. 29 1/2 W. 13 "
- 17 S. 39 1/2 W. 17 "
- 18 S. 21 1/4 W. 20 "
- 19 S. 31 W. 72 to "

Beech

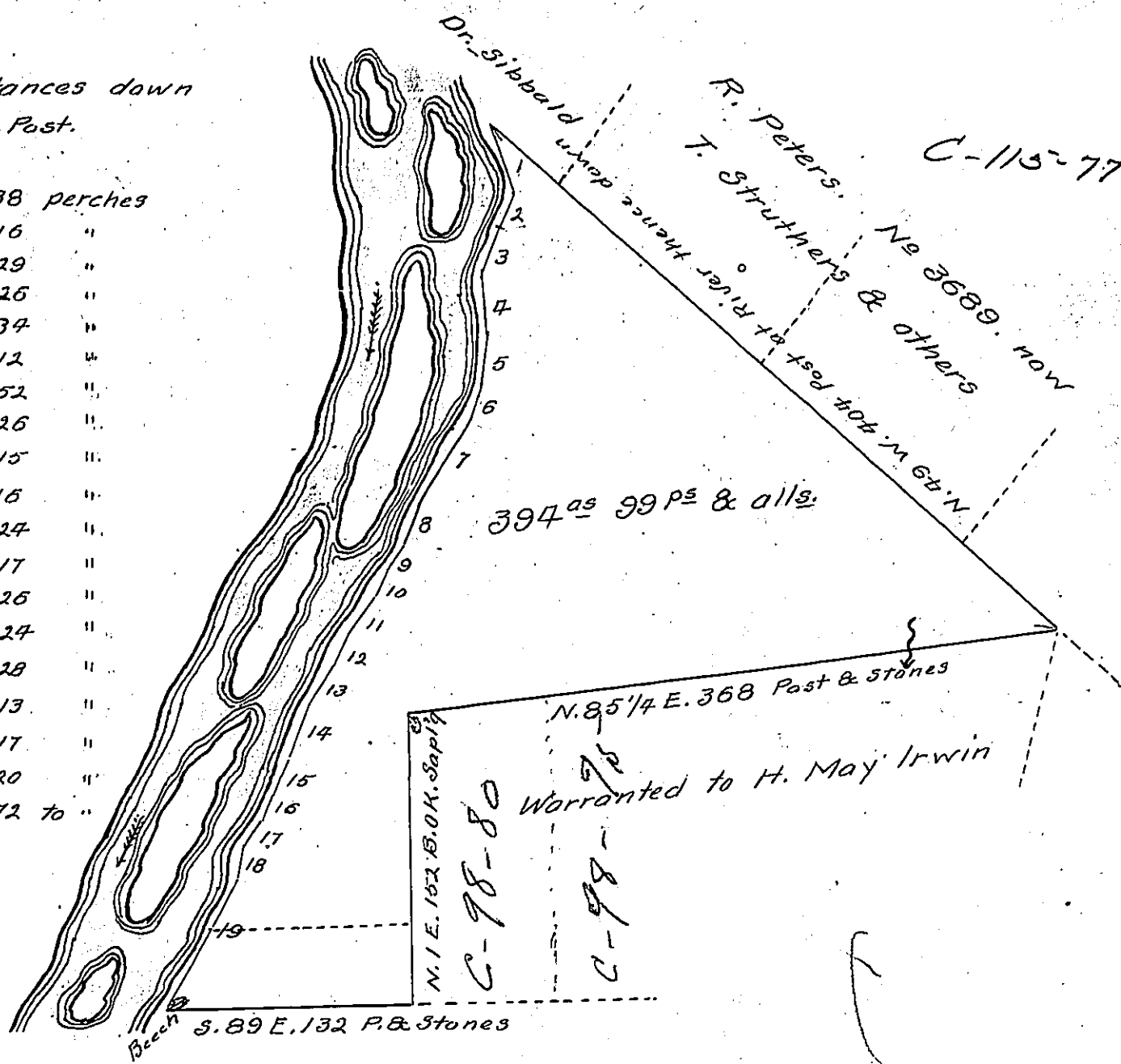

Heirs. of H. May
C. 144 141

Draft of a tract of land Situate in Tionesta Township Venango County, East of and adjoining the Allegheny River.

Surveyed May 10th 1861 in pursuance of a warrant granted to Mary Dale (in trust for the legatees of Jesse Dale) said warrant dated 9th day of January A. D. 1861 and Contains as above three hundred & ninety four acres, ninety nine perches & alls. of Six Pr. Ct. for Roads &c.

Wm Hilands

C. S.

Hon. Wm H. Keim

Surveyor General.

IN TESTIMONY that the above is a copy of the original remaining on file in the Department of Internal Affairs of Pennsylvania, made conformably to an Act of Assembly approved the 16th day of February, 1833, I have hereunto set my Hand and caused the Seal of said Department to be affixed at Harrisburg, this thirtieth day of June 1904

Isaac P. Brown
Secretary of Internal Affairs.